

USER MANUAL

PM-837

MULTIMEDIA WALL PLATE WITH USB AND BLUETOOTH



MAJORCOM:

Manual to download in PDF format on www.majorcom.fr

TABLE OF CONTENTS

1. PRODUCT FEATURES	3
2. BASIC FUNCTIONS	4
2.1 Description of music controller	4
2.2 On, off and standby	4
3. PLAY FUNCTIONS	5
3.1 FM	5
3.2 USB	6
3.3 SD	7
3.4 BLUETOOTH	7
3.5 AUX	8
4. SETTINGS	9
4.1 System settings	9
4.2 System upgrade	9
4.3 Bluetooth setup	10
5. REMOTE CONTROLLER	12
6. TECHNICAL CHARACTERISTICS	13
7. PRODUCT DIMENSION	14
8. INSTALLATION AND WIRED	15
9. INSTALLATION	16
9.1 Concealed installation	16
9.2 Visible installation	17
9.3 Dismounting	18
10. PACKING LIST	19

1. PRODUCT FEATURES

- Convenient and efficient music control center.
- 3.5" TFT LCD display, capacitive touch operation.
- Multiple music connection modes to be selected, including FM, SD, USB, BLUETOOTH, AUX.
- Supports MP3, VMA, WAV, FLAC.
- Supports adjustable sensitivity of auxiliary input.
- Supports FM radio, can automatically or manually receive channels, and can store 20 channels.
- Wide voltage input, suitable for 110~240VAC, 50/60Hz.
- Type D differential output.
- Supports the control operation of the infrared remote controller.
- Supports RS485 communications.

2. BASIC FUNCTIONS

2.1 DESCRIPTION OF MUSIC CONTROLLER

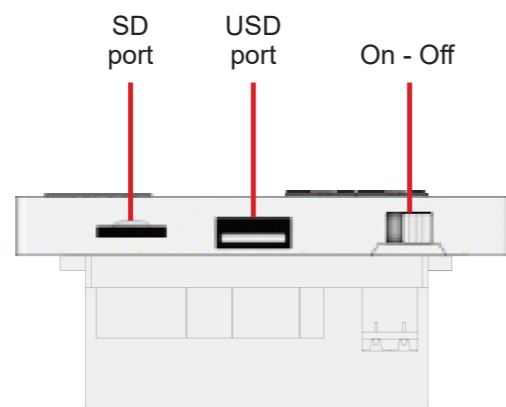
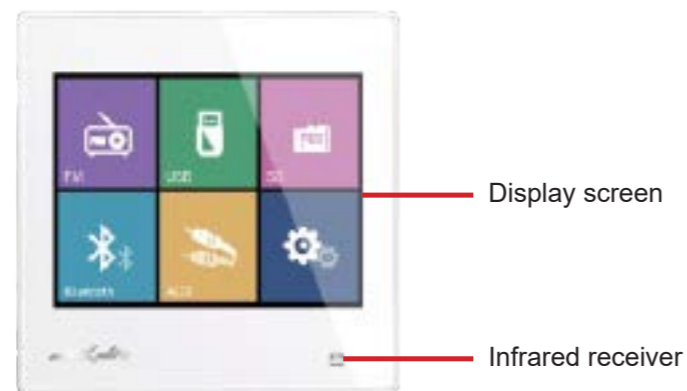

2.2 ON, OFF AND STANDBY

ON : turn the on-off key right, it will be powered on.

OFF : turn the on-off key left, it will be powered off.

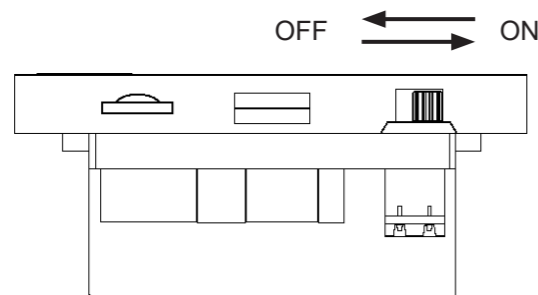

3. PLAY FUNCTIONS

3.1 FM

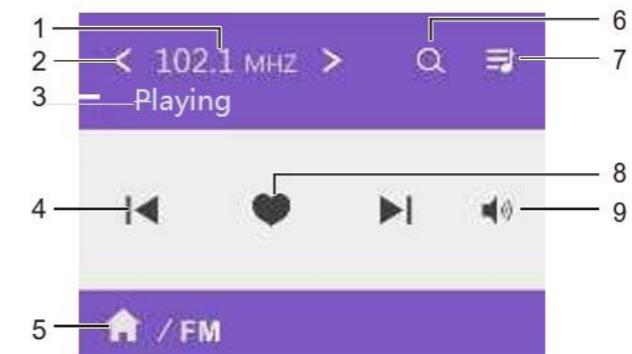

Figure 1

Double click the **FM** icon on the main screen to enter the radio mode :

1. Displays the **current radio frequency**.
2. **Radio frequency spinner button** : < reduce the current frequency value, > increase the current frequency value. Long press < or > semiautomatic search for radio frequency, search for available channels, stop search.
3. **Status** display.
4. Switch the **radio button** to switch the radio forward or backward.
5. **Home / Current mode** : returns to the **home page** and displays the **current menu**.
6. **Fully automatic search button** : search the available frequency will automatically save to the radio list.
7. **Radio list button** : click enter the radio list interface (Figure 2).
8. **Save / cancel the radio button** : save the current radio channel to the radio list, or front channel cancel save.
9. **Volume button** : click the icon to mute, drag the right volume control  , you can adjust the volume size.



Figure 2

1. **Radio list display area** : displays the already stored radio station. Increase or decrease the radio in the list by saving / canceling the radio button in the FM main interface.
2. **Radio list navigation bar** : when you have more than one page, you can turn the page up and down.
3. **Return button** : returns to the FM player interface.

3.2 USB

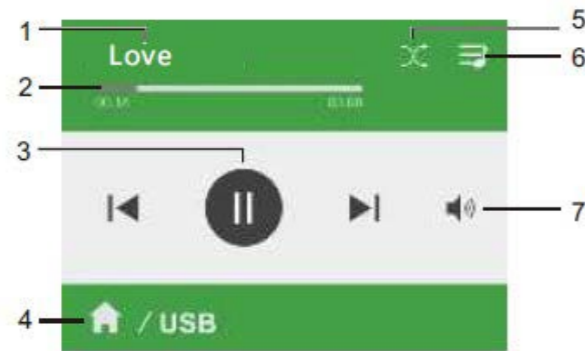



Figure 3

Double click the **USB** icon on the main screen to enter the USB play mode :

1. Displays the current song's information.
2. Song's playback progress bar.
3. Play control button, followed by : previous song, play / pause, next song.
4. **Home / Current mode** : returns to the **home page** and displays the **current menu**.
5. Play mode button.
6. Playlist button, click enter playlist interface (Figure 4)*.
7. **Volume** button : click the icon to mute, drag the right volume control  , you can adjust the volume size.

* There should be no more than 20 directories in the USB/SD card root directory.



Figure 4

1. Return the previous directory.
2. **Playlist display area** : displays the tracks in the USB memory.
3. **Playlist navigation bar** : when you have more than one page, you can turn the page up and down.
4. **Return button** : returns to the USB player interface.

3.3 SD

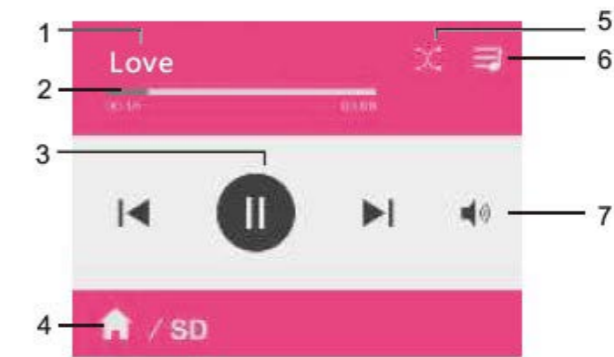



Figure 5

Double click the **SD** icon on the main screen to enter the SD play mode :

1. Displays the current song's information.
2. Song's playback progress bar.
3. Play control button, followed by : previous song, play / pause, next song.
4. **Home / Current mode** : returns to the **home page** and displays the **current menu**.
5. Play mode button.
6. Playlist button, click enter playlist interface (Figure 4)*.
7. **Volume** button : click the icon to mute, drag the right volume control  , you can adjust the volume size.

* There should be no more than 20 directories in the USB/SD card root directory.

3.4 BLUETOOTH

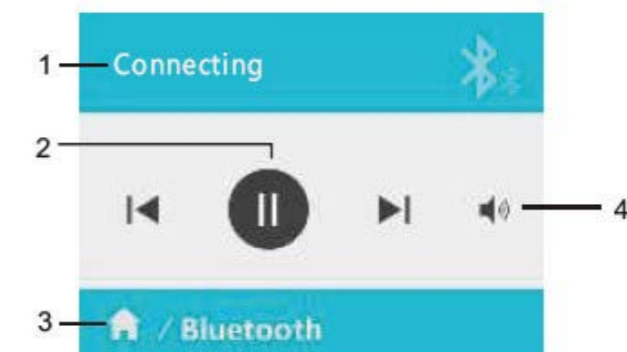



Figure 6

Double click the **Bluetooth** icon on the main screen to enter the Bluetooth play mode :

1. Displays Bluetooth connection status.
2. Play control button, followed by : previous song, play / pause, next song.
3. **Home / Current mode** : returns to the **home page** and displays the **current menu**.
4. **Volume** button : click the icon to mute, drag the right volume control  , you can adjust the volume size.

3.5 AUX



Double click the **AUX** icon on the main screen to enter the AUX play mode :

1. **Volume** button : click the icon to mute, drag the right volume control  , you can adjust the volume size.
2. **Home / Current mode** : returns to the **home page** and displays the **current menu**.

4. SETTINGS

4.1 SYSTEM SETTINGS

Double click the main interface  icon to enter the system settings interface :

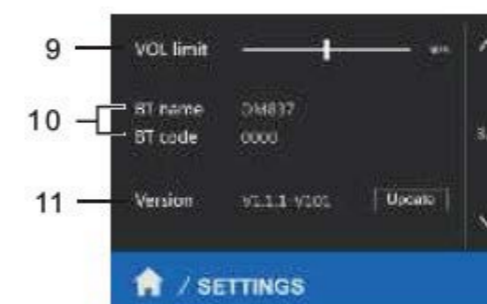
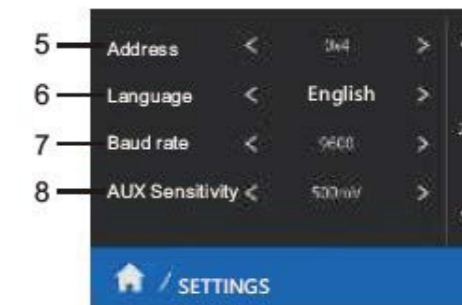

In the settings interface, you have the following options :

1. Backlight, can set how long after the display automatically turn off.
2. Brightness adjustment.
3. Tweeter settings.
4. Bass settings.
5. Set the address of RS485.
6. System Language Set.
7. Baud Rate Set.
8. AUX Sensitivity Set.
9. Maximum volume limit.
10. Displays Bluetooth Name and Password. (Default: DM837:0000)
11. System Version Information.

4.2 SYSTEM UPGRADE

This device supports USB upgrade. Please put the upgrade program file in the root directory.

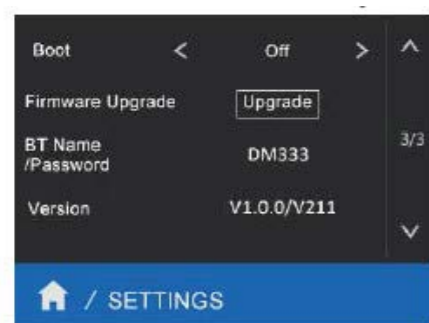

(Settings)



(Upgrade program)



(Upgrade program detected)

- When USB disk is inserted, and master firmware upgrade program file is detected, click **Upgrade Master** to upgrade. The upgrade succeeds after the device reboot automatically.
- When the Bluetooth firmware upgrade program file is detected, please click **Upgrade Bluetooth** to upgrade. It is recommended to restart the device manually after the pop-up window disappears automatically.
- **Please do not operate the equipment during the upgrade process.**

4.3 BLUETOOTH SETUP

1. Please prepare the device, pc, and USB flash drive before modifying.
2. Insert the USB disk into the USB port of the device, and then unplug it after about 10 seconds to access the computer, at this time find the **BT_INFO.txt** file in the root directory of the USB disk.
3. Please click the **BT_INFO.txt** files to modify the Bluetooth name and password in the corresponding location and save it.

Note: The Bluetooth name only supports English and 20 digits maximum. The password only supports 4 digits. If the password is not 4 digits, it will default to '0000' when modified.

4. Then unplug the USB disk and insert it into the USB port of the device. Please wait a few seconds before entering the setting interface of the device, then turns to the third page, and the **Bluetooth name/password** item in the interface will appear. The **Modify** button, as shown in the figure below, will not appear if there is no modification of the content in the **BT_INFO.txt** file. At this time, please click the **Modify** button, the system will automatically restart and complete the modification.

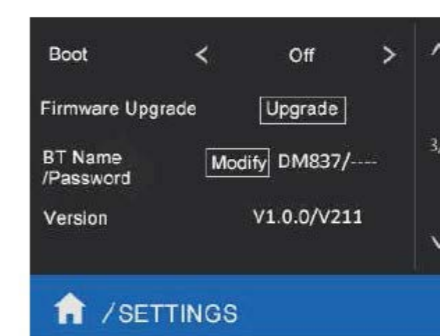

5. REMOTE CONTROLLER

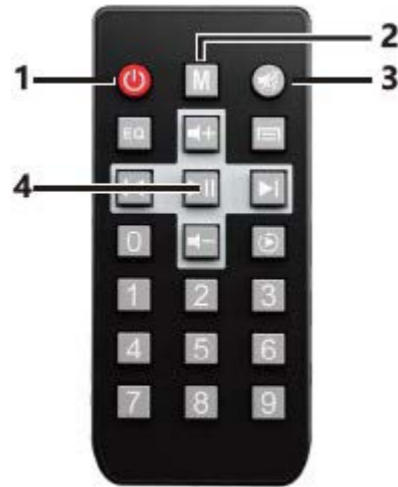

1. **Standby switch.**
2. **Mode selection.** Click the key, it will successively and circularly display FM radio receiver, SD card, USB, SD, BLUETOOTH, AUX.
3. **Mute.**
4. **Play control area.** Able to play/pause, move to previous and next songs, and control the volume.

6. TECHNICAL CHARACTERISTICS

Modèle	PM-837
Power input	~110-240V/50/60Hz
Output power	2 x10W
Rated impedance	8 ohms
Total harmonic distortion	≤1% (1KHz, 1W, 8Ω)
Signal-to-noise ratio	>71dB
Frequency response	50Hz - 18KHz
Sensitivity of auxiliary input	AUX: 1.0V
Aux output	odBV
Audio format	MP3, WMA, WAV, FLAC
Bluetooth	BT4.1
Control Interface	RS485
Storage type	SD card, USB
Dimension	86x86x38mm
Net Weight	0.2kg
Remote controller	
Effective emission angle	60°
Remote control range	10m
Remote control battery	CR2032

7. PRODUCT DIMENSION

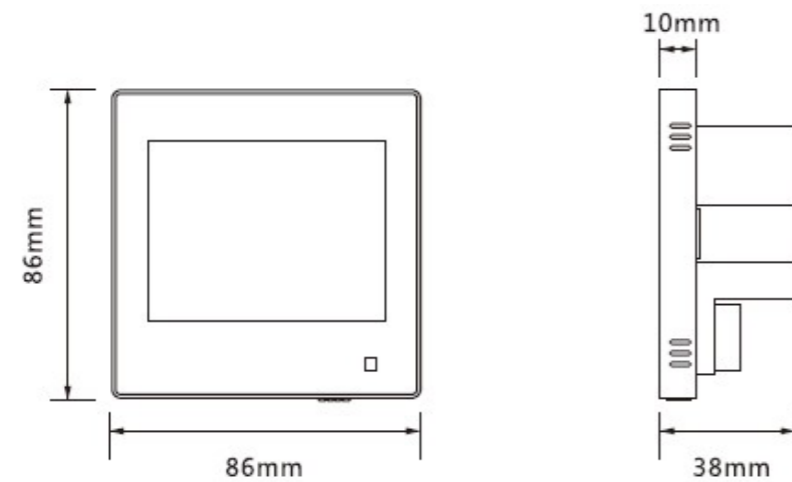

8. INSTALLATION AND WIRED

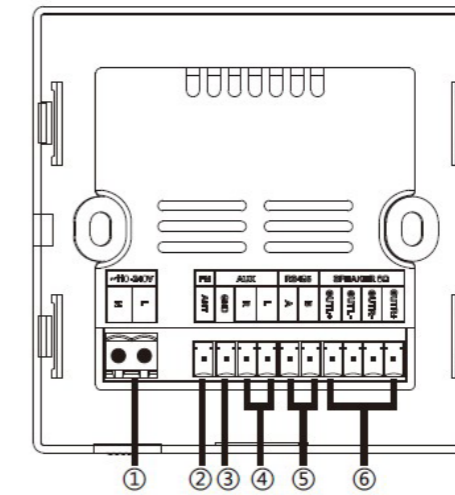

Back of the amplifier

1. Power input : ~110-240V
2. FM antenna
3. Signal ground
4. Audio input 1 (2×0.3mm² double-shielded audio cable)
5. RS485
6. Power amplifier output (Oxygen-free copper speaker cable)

NOTE : All wire connections shall not be naked.

Function	Symbol	Name
Power input	N	Null
	L	Live
FM	ANT	FM antenna
GND		Signal ground
AUX IN	R	Audio input right
	L	Audio input left
RS485	A	A
	B	B
Power amplifier output 8Ω	OUTL+	Left speaker positive terminal
	OUTL-	Left speaker negative terminal
	OUTR-	Right speaker negative terminal
	OUTR+	Right speaker positive terminal

9. INSTALLATION

9.1 CONCEALED INSTALLATION

Note : the box depth should not be less than 40mm.

1. Open a groove suitable for the box dimension on the wall needing installation, and based on the positions of screw holes at the four corners of the bottom surface of the box, drill holes on the wall groove, and prepare to connect lines. **Please arrange the line connection according to the actual hole position of the purchased box.**

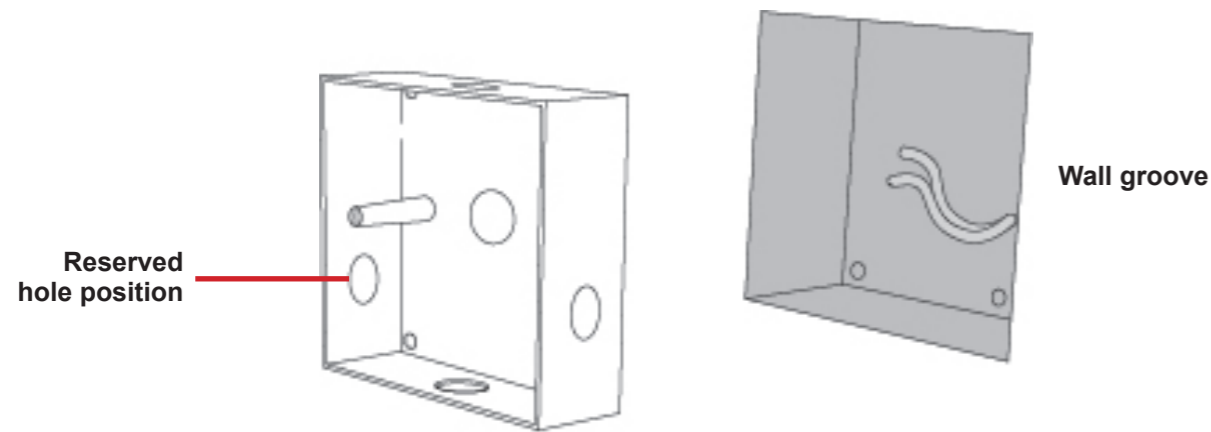

2. Thread the line end through the reserved hole positions around the box. Put the box in the wall groove, and fix the box in the wall groove securely with four expansion screws.

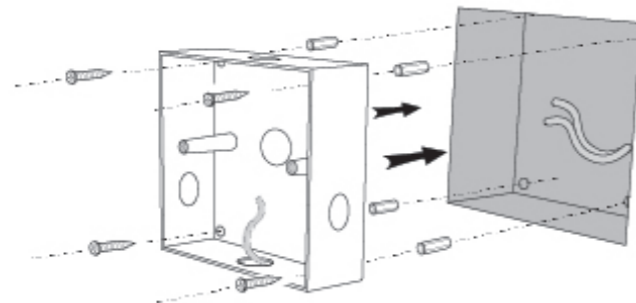

3. As show in the following figure, Select the two clips in the direction of A or B, outer open edge outward, so snap out of and be careful to separate the amplifier front panel and the base.

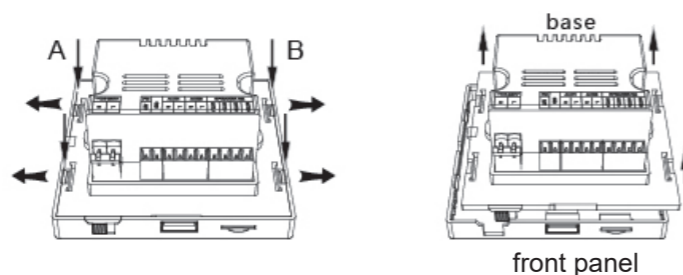

4. Connect the line end with the port on the base of the amplifier, and fix the base shell on the two mounting columns with two screws.

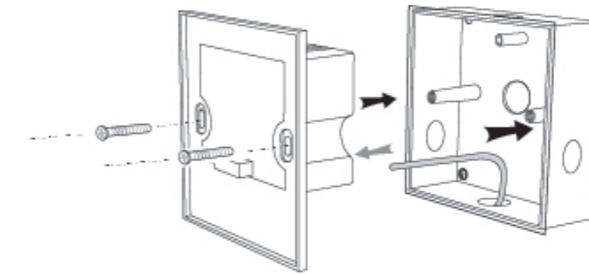

5. Buckle the PM-837 front panel on the base on the wall, and check if the front panel buckles the base completely. **Caution: When the current panel and fasten the base, where pins are inserted in front panel holes and pins must not be bent or damaged, otherwise it will cause damage to the amplifier seriously.**

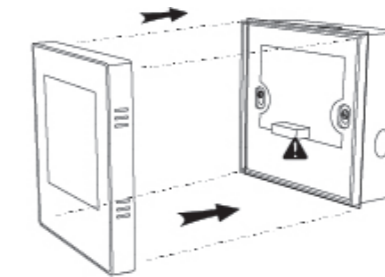

9.2 VISIBLE INSTALLATION

Note : the box depth should not be less than 40mm.

1. According to the four corners of the bottom surface of the box screws holes, drilled hole in the wall to be installed. the wire connector through the hole of the box reserved bits, using four self-tapping screws to fix the box on the wall. **Please arrange the line connection according to the actual hole position of the purchased box.**

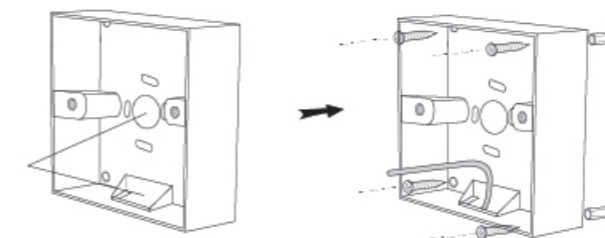

2. Please refer to **Concealed installation of step 3, step 4 and step 5** to complete Setup.

9.3 DISMOUNTING

1. Find the right side of the front panel and the base binding site of gap.

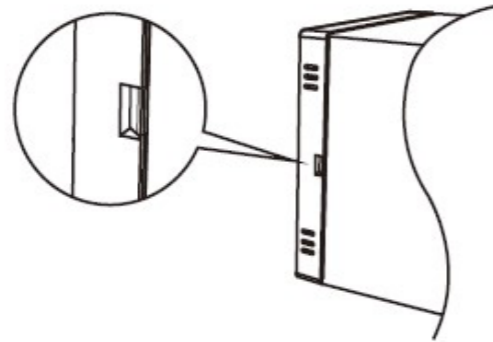

2. Slotted screwdriver with buckle part of the alignment gap, carefully pry the clips.

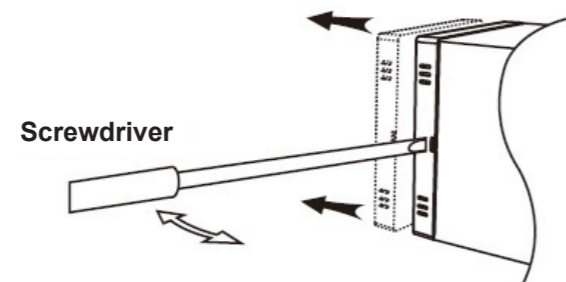

10. PACKING LIST

- PM-837 multimedia wall plate
- Remote controller



PM-837

**MULTIMEDIA WALL PLATE
WITH USB AND BLUETOOTH**

User manual